

E Series Touch Panel

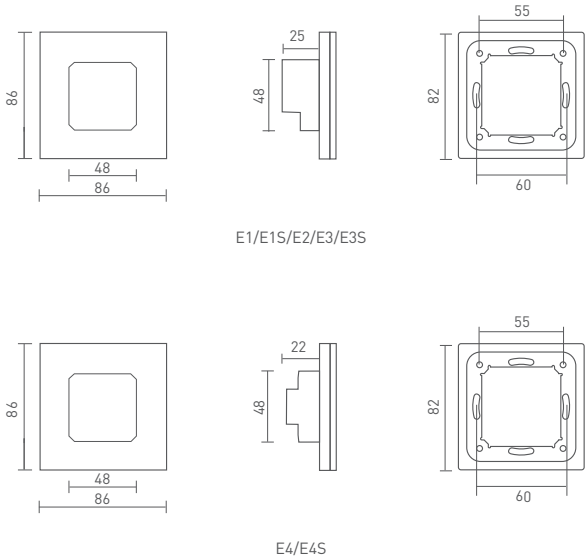

Manual
www.ltech-led.com

Product Size Unit: mm



System diagram

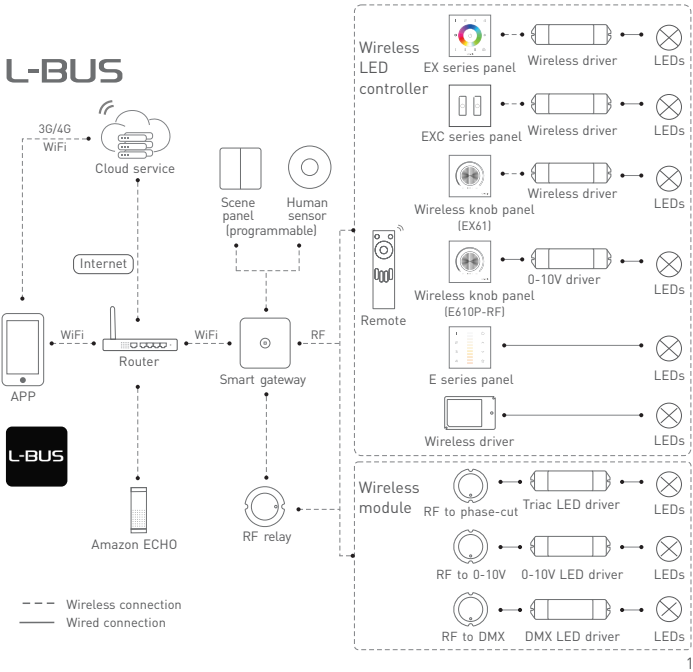

Product Features

- 2 in 1 function: RF wireless control and PWM power output.
- Power output, lamps can be connected directly, easy and convenient.
- Touch keys with chord and LED indicator.
- Adopts capacitive touch control technology on the full color circle makes LED dimming selection more user-friendly.
- Touch panel can be controlled by remote directly or smart phone if add a gateway.

Technical Specs

Model	E1	E1S	E2	E3	E3S	E4	E4S
Control Type	Dimming		CT	RGB		RGBW	
Input Voltage	12-24Vdc						
Wireless Frequency	RF 2.4GHz						
Current Load	4A×2CH Max. 8A		Max. 4A	4A×3CH Max. 12A		3A×4CH Max. 12A	
Output Power	[0~48W...96W]×2CH Max. 192W		0~48...96W	[0~48W...96W]×3CH Max. 288W		[0~36W...72W]×4CH Max. 288W	
Protection	Short circuit / Over current protection, auto recovers. Reverse connection protection.					Reverse connection protection.	
Working Temp.	-20℃~55℃						
Dimensions	L86×W86×H36[mm]						
Package Size	L113×W112×H50[mm]						
Weight[G.W.]	225g						

* Product with L-BUS logo, supports the function of WIFI-108 advanced mode.



Installation Instruction

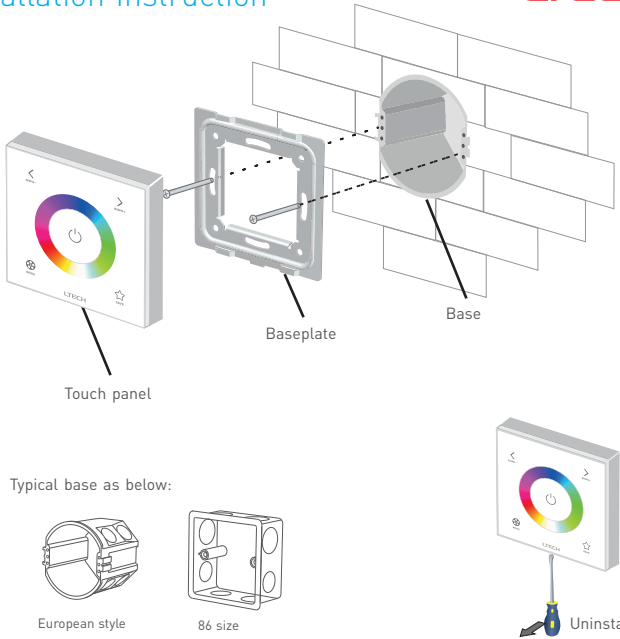

Key Functions

- * When blue indicator light of key is on, long press key to turn on/off buzzer.
- When white indicator light of key is on, long press key to match code.
- * E series touch panel's scene-mode keys are corresponding with WiFi gateway APP's scene-mode, the scenes of panel can be changed by APP or panel.

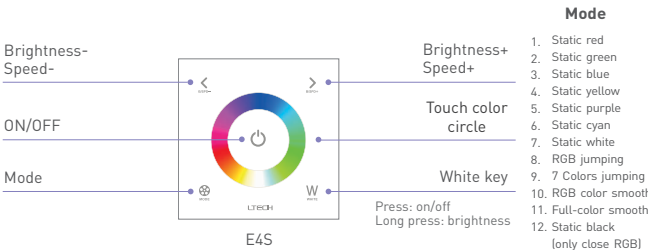
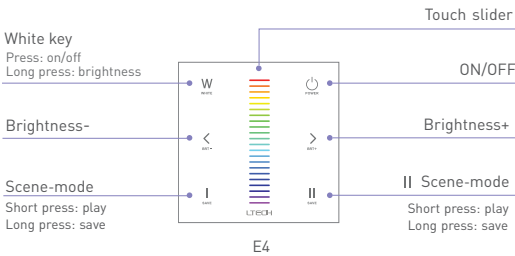
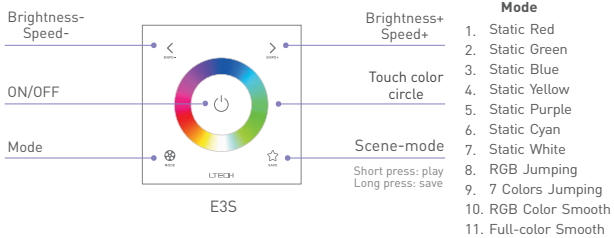
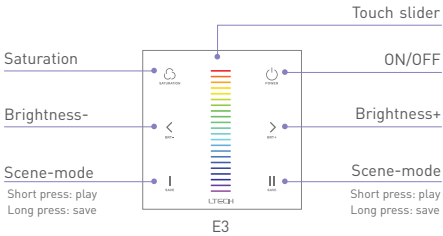
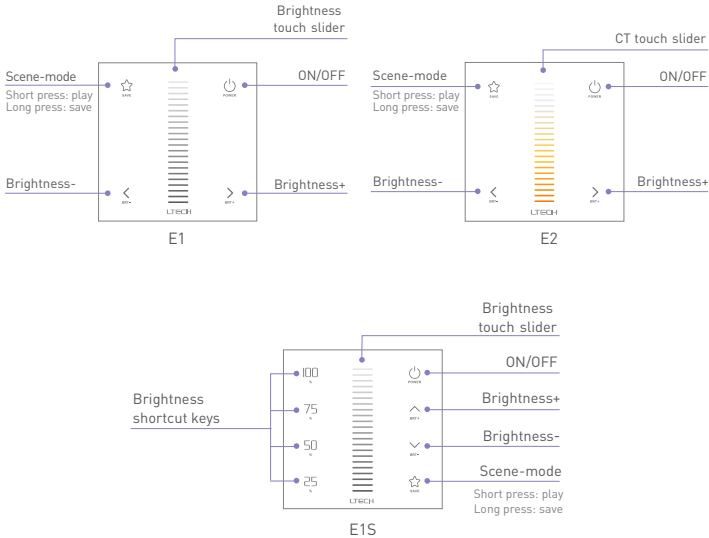

Match Code Sequence

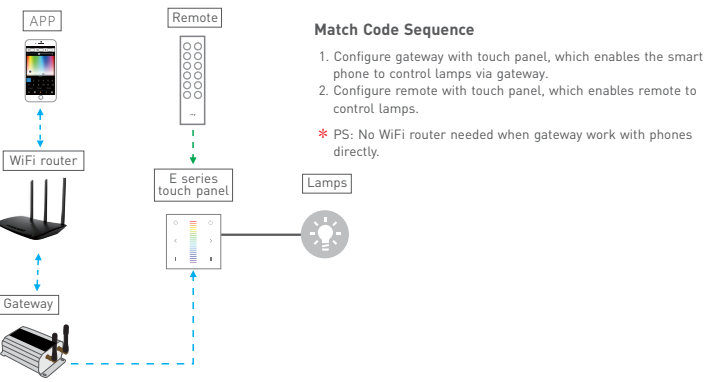

Application Composition

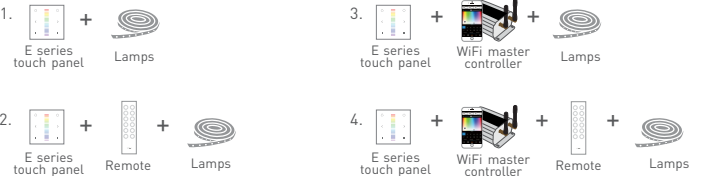

RF Wireless Wiring

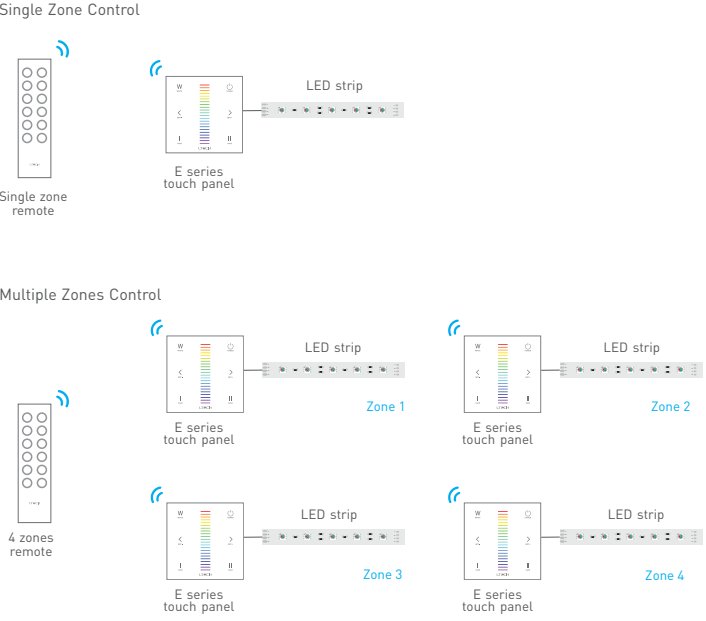

* Touch panels can be sync controlled by multi remotes, please refer to the manual of remote's usage.

Terminals

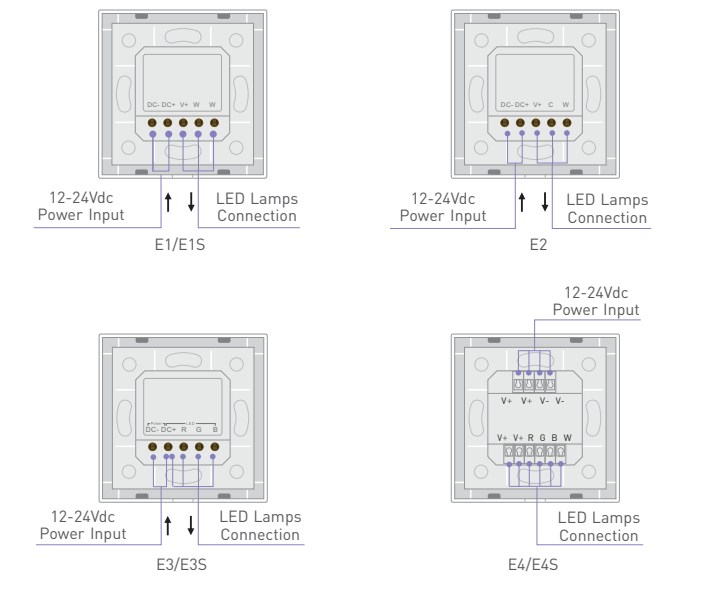

Wiring Diagram

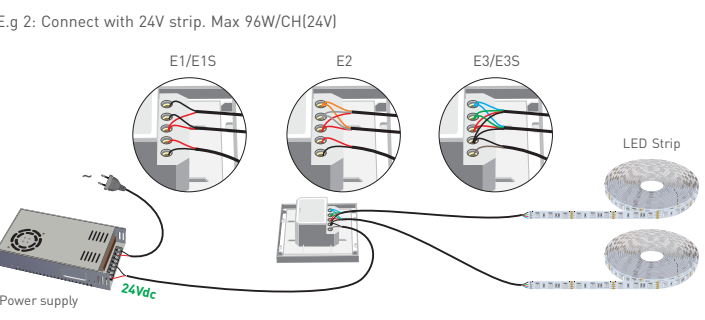
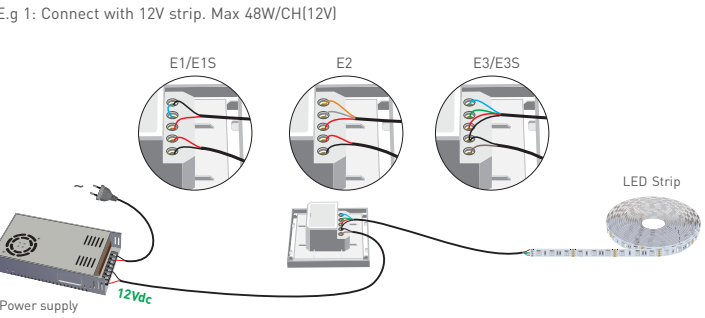

Connect with 12V strip, Max. 36W/CH.

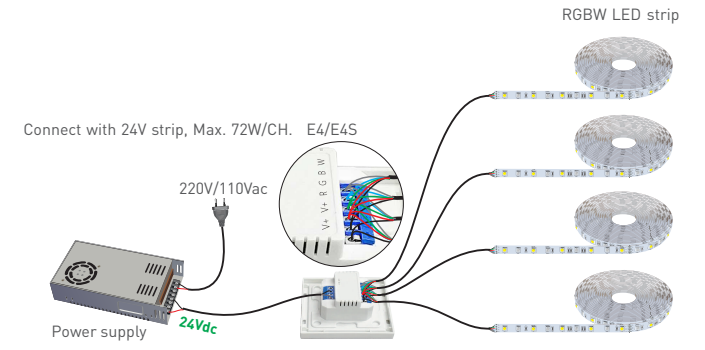
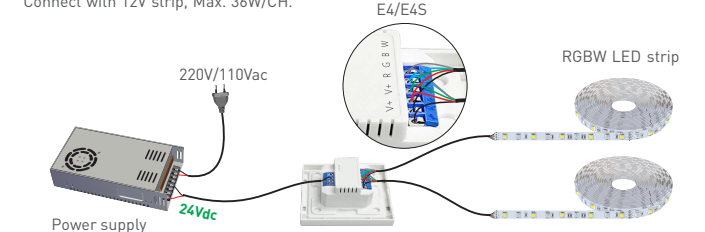

Match Code between Touch Panel & Remote

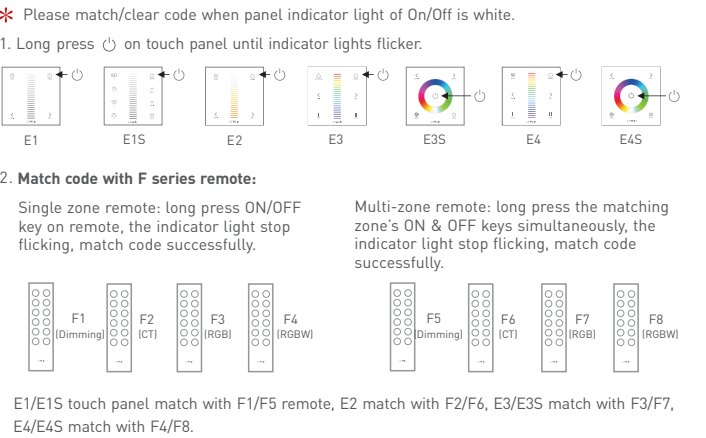

Match Code between Touch Panel & Gateway

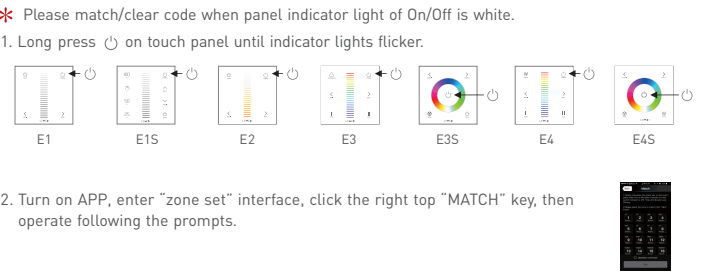

Clear Code

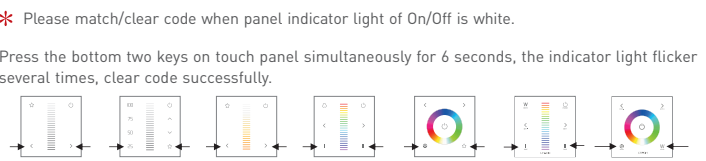

Warranty Agreement:

- 1. We provide lifelong technical assistance with this product:
- A 5-year warranty is given from the date of purchase. The warranty is for free repair or replacement if cover manufacturing faults only.
- For faults beyond the 5-year warranty, we reserve the right to charge for time and parts.
- 2. Warranty exclusions below:
- Any man-made damages caused from improper operation, or connecting to excess voltage and overloading.
- The product appears to have excessive physical damage.
- Damage due to natural disasters and force majeure.
- Warranty label, fragile label and unique barcode label have been damaged.
- The product has been replaced by a brand new product.
- 3. Repair or replacement as provided under this warranty is the exclusive remedy to the customer. LTECH shall not be liable for any incidental or consequential damages for breach of any stipulation in this warranty.
- 4. Any amendment or adjustment to this warranty must be approved in writing by LTECH only.

*No further notice if any changes in the manual.
Product function depends on the goods.
Please feel free to contact our official distributor if any question.