

LED Intelligent CT Driver

- Dimming interface: DALI DT8, Push DIM/CCT
- 2 independently SELV constant voltage output channels.
- DALI DT8, DIM and color temperature adjusting driver.
- Dimming range from 0-100%, LED start at 0.1% possible.
- Color temperature adjusting range: 2500-6000K
- 0-100% flicker-free, High frequency exemption level.
- Over-heat / Over voltage / Over load / Short circuit protection, recover automatically.
- Standby Power Loss < 0.5W
- Full protective plastic housing.
- Compliant with Safety Extra Low Voltage standard.
- Suitable for indoor I / II / III type lamps application.
- Up to 30000-hour life time.

Flicker-free

Achieve the exemption level.

Dimmable:
0.1%-100%

DT8 DIM / CT

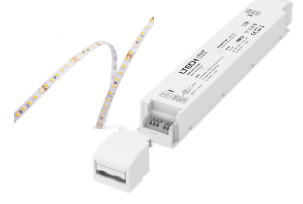

Specification

Model		LM-75-24-U2D2	LM-75-12-U2D2
OUTPUT	Output Voltage	24Vdc	12Vdc
	Output Voltage Range	24Vdc ±0.5Vdc	12Vdc ±0.5Vdc
	Output Current	Max. 3.12A	Max. 6.25A
	Output Power	Max. 75W	
	Output Power Range	0~75W	
	Strobe Level	Exemption assessment level.	
	Dimming Range	0~100%, dimming depth: Max. 0.1%	
	Overload Power Limitation	≥ 102%	
	Ripple & Noise	≤ 200mV	
	PWM Frequency	3600Hz	
INPUT	Dimming Interface	DALI DT8(IEC62386), Push Dim/CCT	
	Input Voltage	100-277Vac ±10% (Max. 90-305Vac)	
	Frequency	50/60Hz	
	Input Current	115Vac ≤ 0.9A, 230Vac ≤ 0.4A, 277Vac ≤ 0.35A	
	Power Factor	PF>0.99/115Vac, PF>0.97/230Vac, PF>0.95/277Vac, at full load	
	THD	≤ 10% at 115Vac, ≤ 14% at 230Vac, ≤ 17% at 277Vac, at full load	
	Efficiency	>92%	>91%
	Standby Power Loss	< 0.5W	
	Inrush Current(typ.)	Cold start 30A at 277Vac	
	Anti Surge	L-N:1KV L,N-PE:2KV	
	Leakage Current	<0.5mA/277Vac	
ENVIRONMENT	Working Temperature	ta: -30°C ~ 50°C tc: 80°C	
	Working Humidity	20 ~ 95%RH, non-condensing	
	Storage Temp., Humidity	-40°C ~ 80°C, 10~95%RH	
	Temp. Coefficient	±0.03%/°C (0-50°C)	
	Vibration	10~500Hz, 2G 12min./1cycle, period for 72min. each along X, Y, Z axes.	
PROTECTION	Over-heat Protection	Shut down the output when PCB temp. ≥ 110°C, auto recovers	
	Over Voltage Protection:	Shut down the output when non-load voltage ≥ 26V, re-power on to recover after fault condition is removed.	Shut down the output when non-load voltage ≥ 13V, re-power on to recover after fault condition is removed.
	Over Load Protection	Shut down the output when current load ≥ 102%, auto recovers.	
	Short Circuit Protection	Shut down automatically if short circuit occurs, auto recovers.	
SAFETY & EMC	Withstand Voltage	I/P-O/P: 3750Vac	
	Isolation Resistance	I/P-O/P: 100MΩ/500VDC/25°C/70%RH	
	Safety Standards	IEC/EN61347-1, IEC/EN61347-2-13	
	EMC Emission	EN55015, EN61000-3-2 Class C, IEC61000-3-3	
	EMC Immunity	EN61000-4-2,3,4,5,6,8,11 EN61547	
	Strobe Test Standard	IEEE 1789	
OTHERS	Dimension	292×43×30mm(L×W×H)	
	Packing	296×44×33mm(L×W×H)	
	Weight(G.W.)	300g±10g	

* The driver is suitable for connecting resistor current-limiting LED fixture (e.g. LED strip). The instantaneous surge current will be several times increased if connecting built-in constant current IC current-limiting LED fixtures, the driver will activate the overloaded protection (hiccups flickering). When you order, please remark controlling the constant current LED fixture (e.g. underground light, LED wall washer, constant current LED strip, etc.), then we can prepare the special programs.

Dimensions

Unit: mm

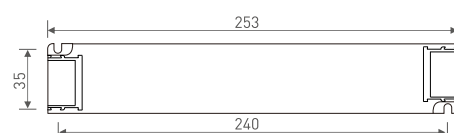
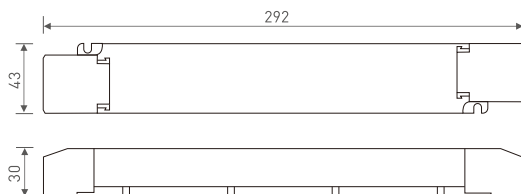

Wiring diagram

DALI DT8 Connection

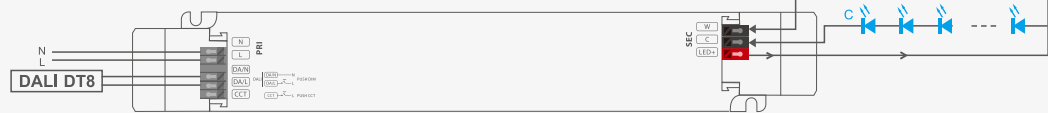

DIM: 0-100% brightness adjustment.
CCT: 2500-6000K color temperature adjustment.

Push DIM/CCT Connection

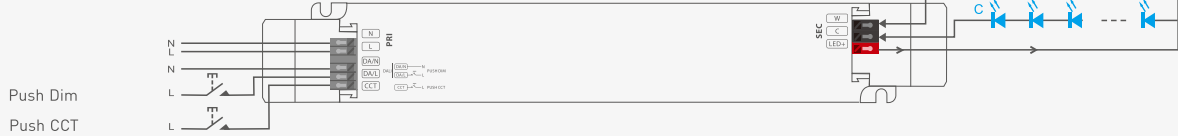

DIM: 0-100% brightness adjustment.
CCT: 2500-6000K
Color temperature adjustment.

* Dimming interface priority: First DALI DT8, next Push DIM/CCT.

* Adopting constant power program design, it keeps the same brightness in color temperature dimming, twice the rated power load can be connected.
75W driver, 75W X 2CH load can be connected, the total power of the 2 channels will be kept in 75W.

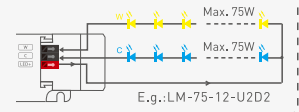

Push DIM/CCT



Reset switch

DIM

- On/off control: Short press.
- Stepless dimming: Long press.
- With every other long press, the brightness goes to the opposite direction.
- Dimming memory: Brightness will be the same as previously adjusted when turning off and on again.

CCT

- Color temperature adjustment: Long press.
- With every other long press, the color temperature level goes to the opposite direction.
- Color temperature memory: Color temperature will be the same as previously adjusted when turning off and on again.

Application of protective cover

Wire pressing board

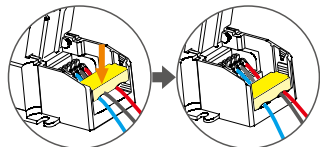

Push the wire pressing board to fix the wire.

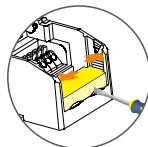

Push outward the side plate, meanwhile use the tool to uninstall the wire pressing board.

Uninstall protective cover

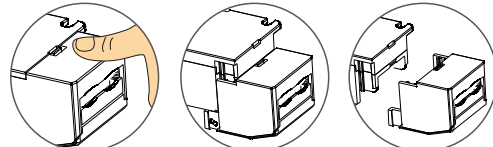

Break off the bottom left and right to remove the protective cover.

Relationship diagrams

Efficiency vs load

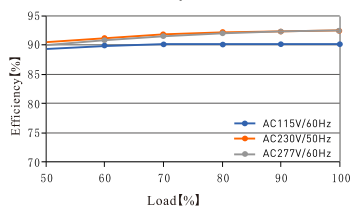

Power factor characteristic

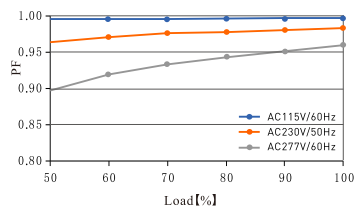

THD vs load

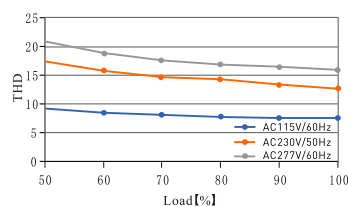

Over load diagram

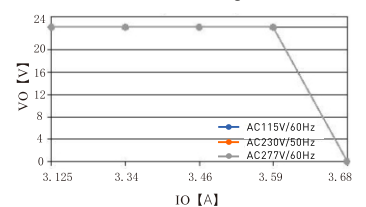

LM-75-24-U2D2

Efficiency vs load

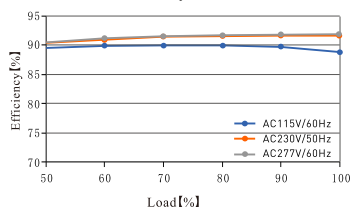

Power factor characteristic

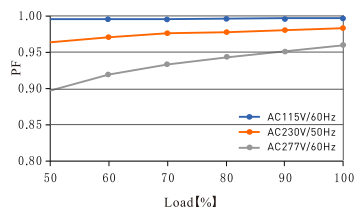

THD vs load

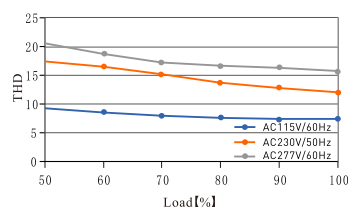

Over load diagram

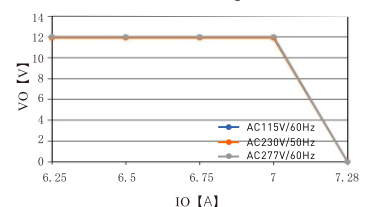

LM-75-12-U2D2